



*Road Running Technical Council  
USA Track & Field*  
**Measurement Certificate**



Name of the course Sandpiper Sprint 5K Distance 5 km  
Location (state) AL (city) Summerdale  
Type of course: Road Race  
Measuring Methods: Bicycle  
Measured By Jon Bowie, 117 Laurel Place, Daphne, AL 36526, jnbowie@gmail.com, 251-209-0887  
Race Contact ,  
Date(s) when course measured: 11/25/2023  
Number of measurements of entire course: 3 Course Configuration: Partial Loop  
Elevation (meters above sea level) Start 34.00 Finish 35.00 Lowest 29.00 Highest 36.00  
Straight line distance between start and finish 52m Drop -0.20 m/km Separation 1.04 %  
Type of surface: Paved 100 % Dirt 0 % Gravel 0 % Grass 0 % Track 0 %  
Effective date of certification: January 16, 2024 Certification code: AL24006JE

Note to Race Director: Use this Certification Code  
in all public announcements relating to your race.

## *Be It Officially Noted That*

Based on examination of data provided by the above named measurer, the course described above and in the map attached is hereby certified as reasonably accurate in measurement according to the standards adopted by the Road Running Technical Council. If any changes are made to the course, this certification becomes void, and the course must then be recertified.

**Verification of Course ---** In the event a National Open Record is set on the course, or at the discretion of USA Track & Field, a verification measurement may be required to be performed by a member of the Road Running Technical Council. If such a remeasurement shows the course to be short, then all pending records will be rejected and the course certification will be cancelled.

***This certification expires on December 31 of the year:*** **2034**

*Jon Elmore*

**AS NATIONALLY CERTIFIED BY:**

Date: January 29, 2024

Jon Elmore - USATF/RRTC Certifier - 3428 Tanglewood Dr SW, Decatur AL 35603  
(256) 476-3517 - jklca5@att.net

# Sandpiper Sprint 5K Summerdale, AL

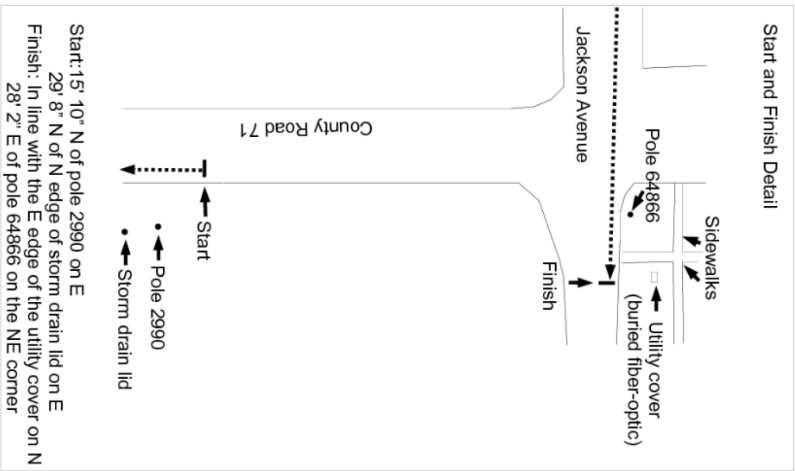
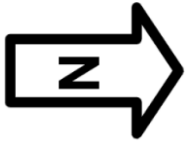

Course was measured on the SPR and the runners have full use of the road unless otherwise noted.

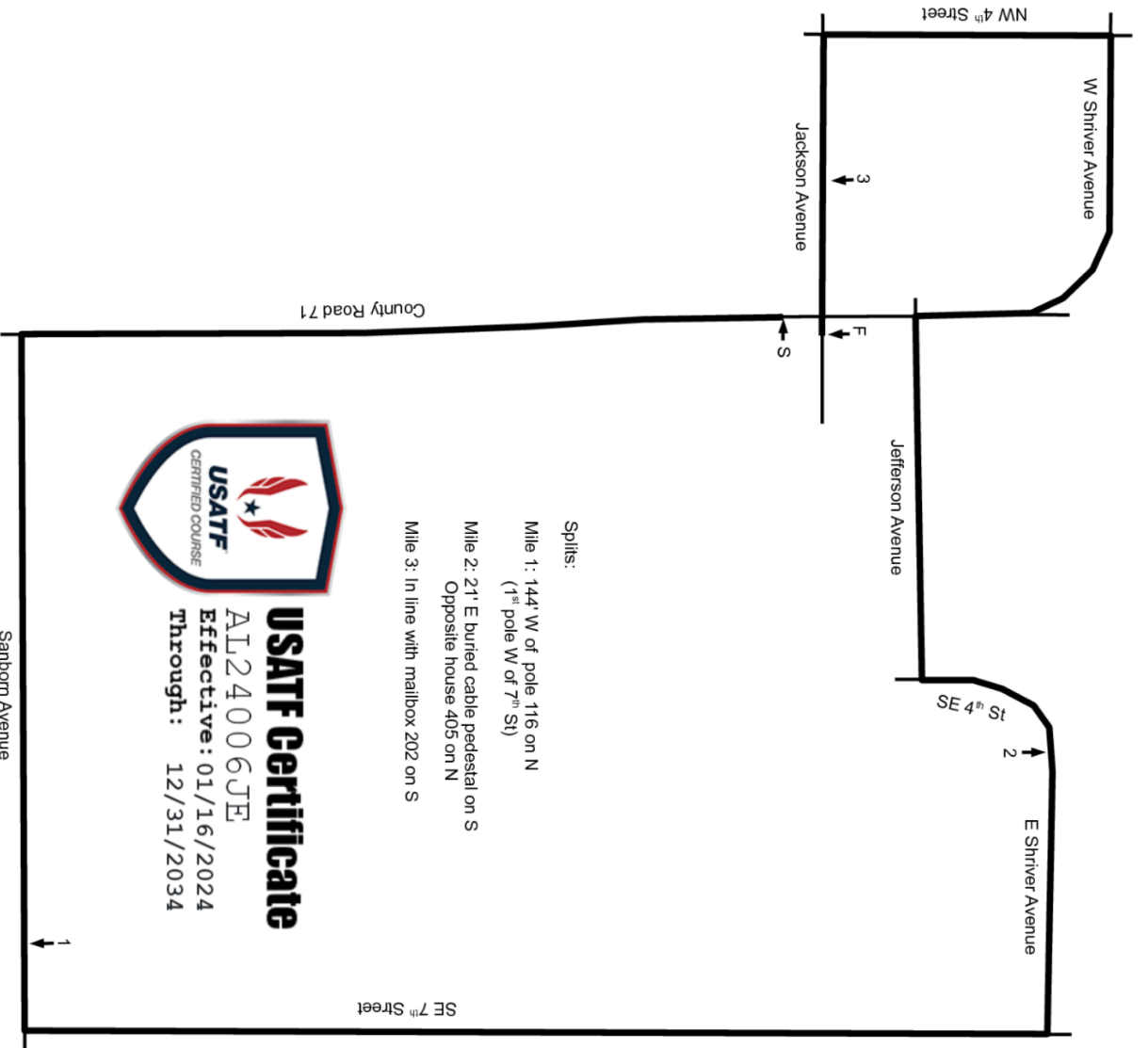

Course was measured on the SPR and the runners have full use of the road unless otherwise noted.